

INSTRUCTIONS FOR INSTALLING THE 320489 MODIFICATION KIT
ON MODEL 35 RO, KSR AND ASR PRIVATE LINE SETS TO PROVIDE
SIGNAL LINE BREAK AND BREAK RELEASE LAMP AND SWITCH

1. GENERAL

- 1.01 The 320489 modification kit provides a signal line break and break release lamp and switch on Model 35 RO, KSR and ASR Private Line Sets.
- 1.02 A break or open line condition is generated by operating the BREAK-BRK RLS key to the front or BREAK position. It is used by any station on the loop to immediately stop transmission over the line by electrically blinding the keyboard. When the break is established, a lamp in the key illuminates. Sets which are not "on" are not capable of breaking the line by accidental operation of the BREAK key.
- 1.03 The operator can restore the equipment's ability to transmit by operating the BREAK-BRK RLS key to the rear or BRK RLS position. The blind across the keyboard signal generator is removed and the break light is extinguished. A BREAK condition does not affect the ability of the set to monitor traffic.
- 1.04 The 320489 kit consists of:
- | | | | | | |
|---|--------|--------------------|---|--------|-----------------------------|
| 5 | 7002 | Washer, flat | 1 | 198019 | Lamp, 6v |
| 1 | 121245 | Clamp, cable | 1 | 319263 | Cable assembly w/
switch |
| 2 | 125005 | Screw | | | |
| 5 | 181241 | Screw w/lockwasher | 1 | 319265 | Bracket, switch mtg. |
- 1.05 For parts ordering information, other than the parts in the kit, and for adjustments and lubrication procedure of related equipment refer to the standardized information.

2. INSTALLATION (Figures 1 to 3)

- 2.01 If the 321765** faceplate is mounted to the cabinet, remove and set aside.
- 2.02 Mount the 319265 switch mounting bracket to the 192270 bracket (located to the right of the keyboard or RO Set face panel) using four 181241 screw w/lockwashers and four 7002 flat washers. Refer to Figure 1.
- 2.03 Remove the socket from the 319263 switch assembly, install the 198019 lamp, replace socket and mount the assembly to the 319265 bracket using the two 125005 screws.

**Indicates color code.

SPECIFICATION 50466S

- 2.04 Close the cover of the cabinet (LAC305 and LAAC305) and check the 319265 bracket for fit. To raise or lower bracket, loosen the four 181241 screws. Adjust for a flush fit with the cabinet cover and tighten screws.
- 2.05 Mount the 321765** faceplate to the cabinet cover using the 198290 set of parts (SOP). (Refer to Figures 2 & 3.) Lower the cover slowly checking the fit between it and the handle of the 319263 cable assembly w/switch. To move the switch and bracket assembly forward or rearward of to the left or right loosen the two 192274 allen head screws holding the 192270 bracket (Figure 1). Adjust the assembly for a good fit with the square hole in the faceplate and tighten screws.
- 2.06 Route the 319263 cable as shown in Figure 3 using a 121245 cable clamp, one 181241 screw and one 7002 flat washer (refer also to Figure 1).
- 2.07 Plug the 12-point connector of the 319263 cable w/switch into its mating connector located in the basic facilities assembly in the LESU.

★ PART OF 320480 MOD. KIT
 ✎ PART OF LAC OR LAAC CABINET

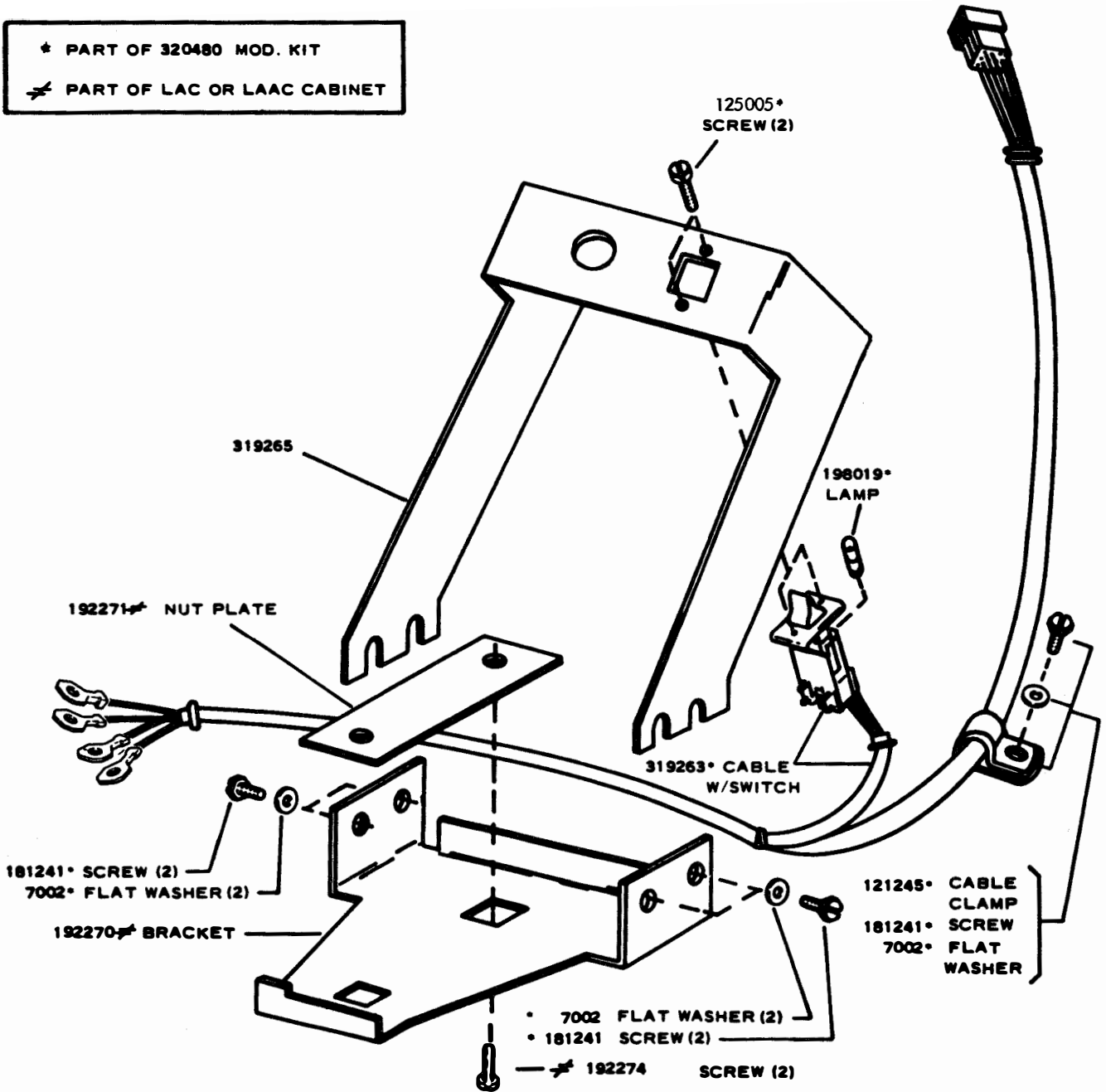

FIGURE 1

320489 BREAK — BRK. RLS. MODIFICATION KIT

50466S

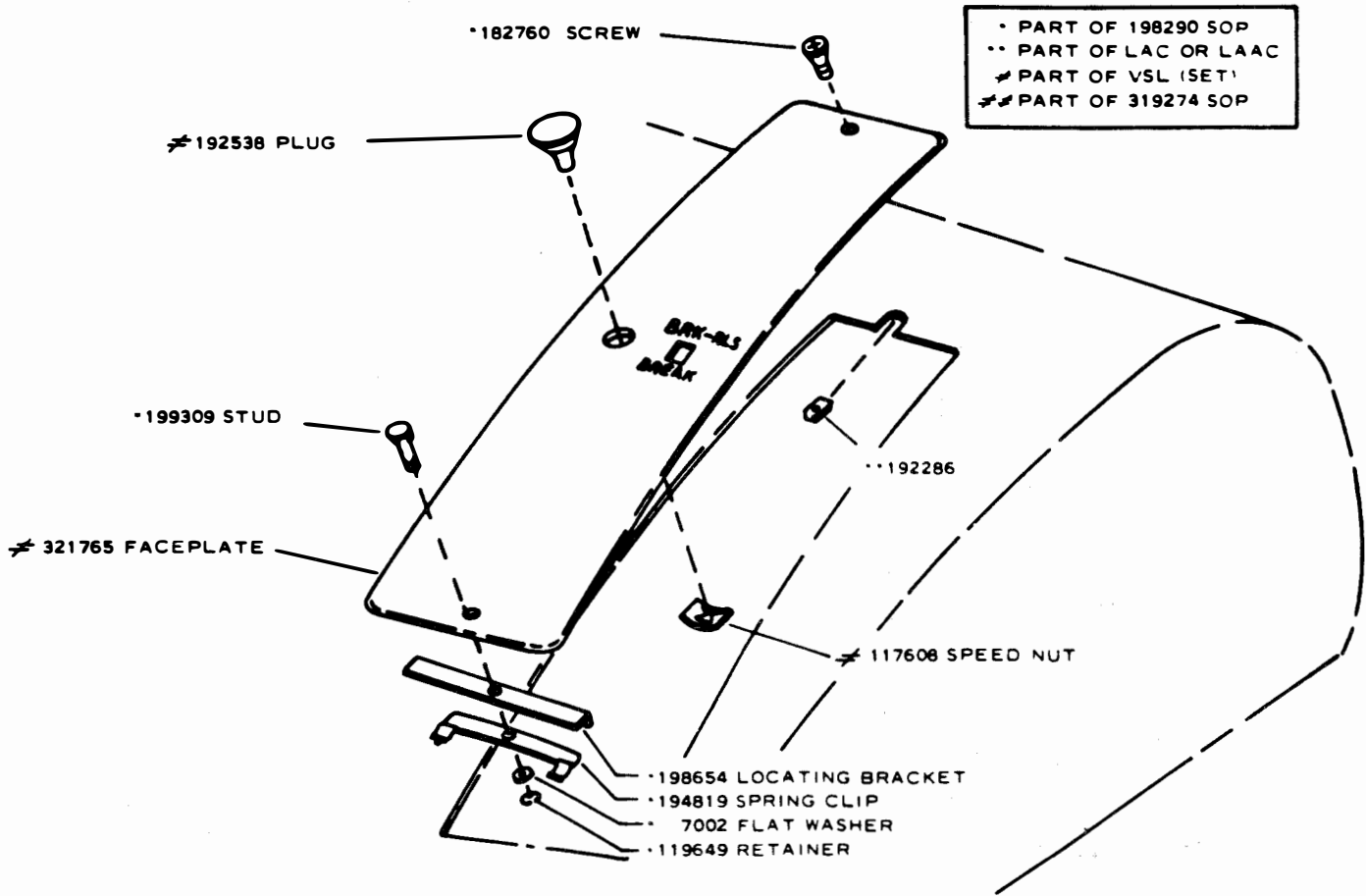

FIGURE 2

ASSEMBLY OF FACEPLATE & ASSOCIATED HARDWARE TO CABINET

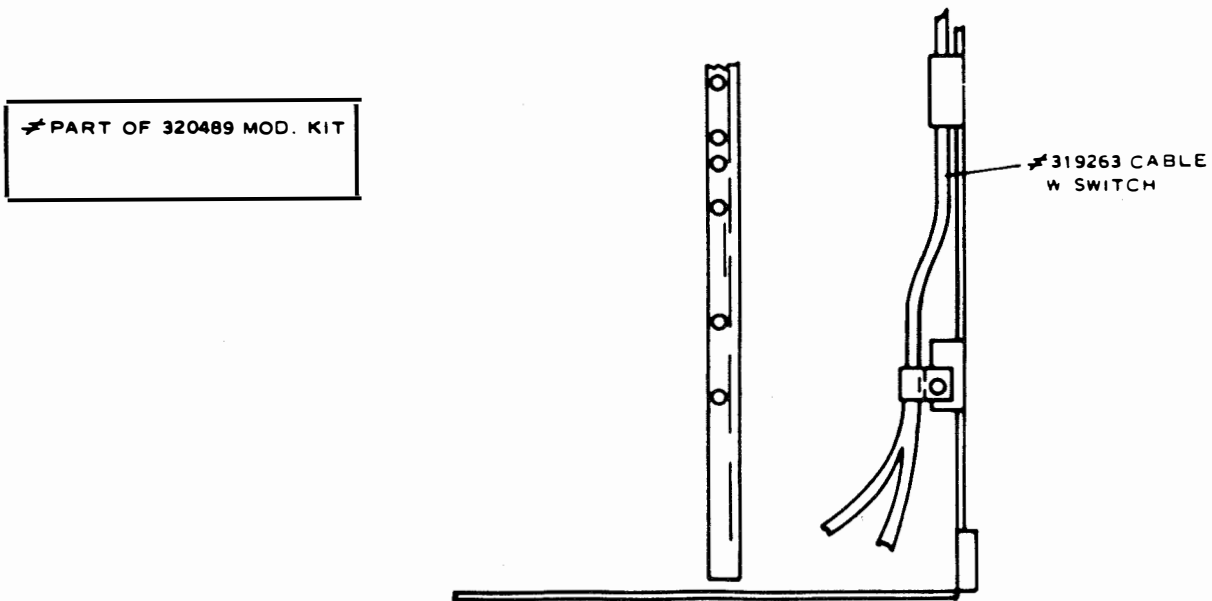

FIGURE 3

CABLE ROUTING DIAGRAM
(RIGHT HAND TOP VIEW OF LAC OR LAAC PAN)