

502 6005 002 ~~502 6005 002~~ CU 286

ALL INFORMATION CONTAINED HEREIN IS UNCLASSIFIED EXCEPT WHERE SHOWN OTHERWISE. IT IS THE POLICY OF THE UNITED STATES GOVERNMENT TO MAKE AVAILABLE TO THE PUBLIC ALL INFORMATION NOT WITHSTANDING ANY RIGHTS IN PATENTS OR OTHER PROPRIETARY RIGHTS THAT MAY BE CLAIMED BY ANY INDIVIDUAL OR ORGANIZATION. THE GOVERNMENT ASSUMES NO LIABILITY FOR ANY INFRINGEMENT OF ANY PATENT OR OTHER PROPRIETARY RIGHTS THAT MAY BE CLAIMED BY ANY INDIVIDUAL OR ORGANIZATION. THE GOVERNMENT ASSUMES NO LIABILITY FOR ANY INFRINGEMENT OF ANY PATENT OR OTHER PROPRIETARY RIGHTS THAT MAY BE CLAIMED BY ANY INDIVIDUAL OR ORGANIZATION.

NOTE:
*FOR INFORMATION ONLY,
CONTRACTOR MAY AT HIS
OPTION DEVIATE FROM
THESE PROCESS DETAILS

*SWE APPROVAL		REVISIONS		
SYM	DESCRIPTION	DATE	APPROVAL	
PR 100 42-6				
A ₂	A ₁ - FINISH NOTE WAS PER MIL-P-12011. A ₂ - ADDED APPL. SM-B-249072, SC-IL-248775.	15 OCT. 59	42428-PC-59 -A1-51	REV'D. PME

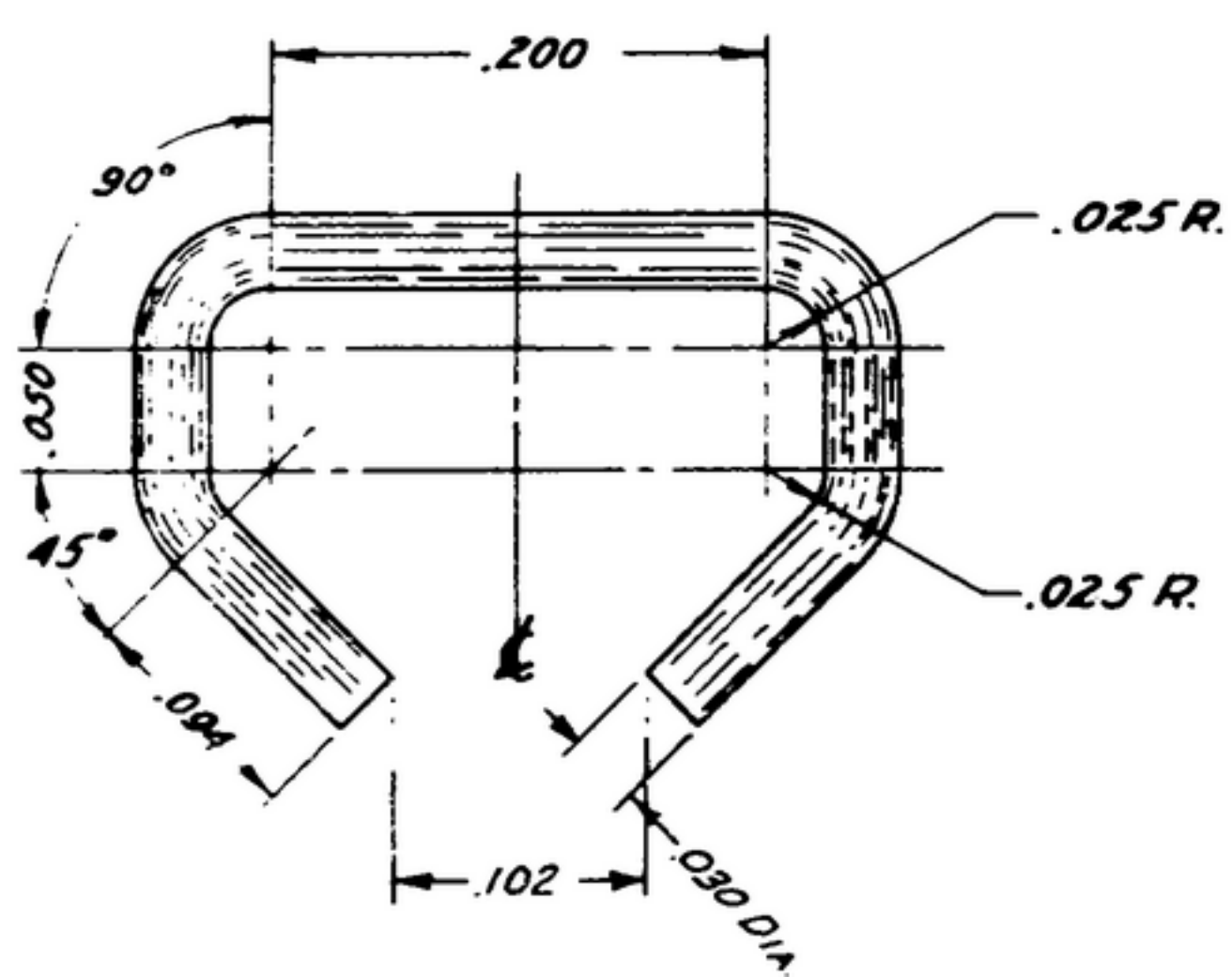

STEEL WIRE, COND 302, COND B, PER SPEC QQ-W-423
1-REMOVE ALL BURRS
A₁ 2-FINISH: E 300 PER SPEC. MIL-F-14072.

QTY	PART NO.	DESCRIPTION	MATL.	MATL. SPEC.
LIST OF MATERIAL				
SPRING				
SIGNAL CORPS ENGINEERING LABORATORIES FORT MONMOUTH NEW JERSEY				
SM-B-170817				

UNLESS OTHERWISE SPECIFIED		AUTHENTICATION	
DIMENSIONS ARE IN INCHES		DRAWN 21052-PH-50-53	
TOLERANCES ON		TRACED P:1070	
FRACTIONS DECIMALS ANGLES		CHECKED <i>Ran</i>	
_____ ±.005 ± 1°		VERIFIED <i>PO BR</i>	
		APPROVED <i>PO BR</i>	
		REVIEWED <i>PME</i>	
		DATE 4, SEPT, 53	
APPLICATION		SCALE 10/1	

A₂

SM-B-249072	SC-DL-248775
SM-B-170814	SC-DL-170759
NEXT ASSY	USED ON