

NOTICE: WHEN GOVERNMENT DRAWINGS, SPECIFICATIONS, OR OTHER DATA ARE USED FOR ANY PURPOSE OTHER THAN IN CONNECTION WITH A SEPARATELY RELATED GOVERNMENT PROCUREMENT OPERATION, THE UNITED STATES GOVERNMENT THEREBY ASSUMES NO RESPONSIBILITY FOR ANY OBLIGATION WHATSOEVER, AND THE FACT THAT THE GOVERNMENT MAY HAVE FURNISHED, PURCHASED, OR IN ANY WAY SUPPLIED THE SAID DRAWINGS, SPECIFICATIONS, OR OTHER DATA IS NOT TO BE REGARDED BY RECIPIENTS AS CONSTITUTING AN IMPLICIT LICENSE OR AUTHORITY TO REPRODUCE OR TRANSMIT IN ANY MANNER, OR TO CONVEY ANY RIGHTS OR PERMISSIONS TO MANUFACTURE, USE, OR SELL ANY PATENTED INVENTION THAT MAY IN ANY WAY BE RELATED THERETO.

THIS DOCUMENT HAS BEEN FURNISHED BY THE GOVERNMENT AND MAY BE REPRODUCED AND USED IN CONNECTION WITH ANY GOVERNMENT PROCUREMENT OR MAINTENANCE OPERATION.

* FOR INFORMATION ONLY. CONTRACTOR MAY AT HIS OPTION DEVIATE FROM THESE PROCESS DETAILS.

REVISIONS

SYM	DESCRIPTION	DATE	APPROVAL
-----	-------------	------	----------

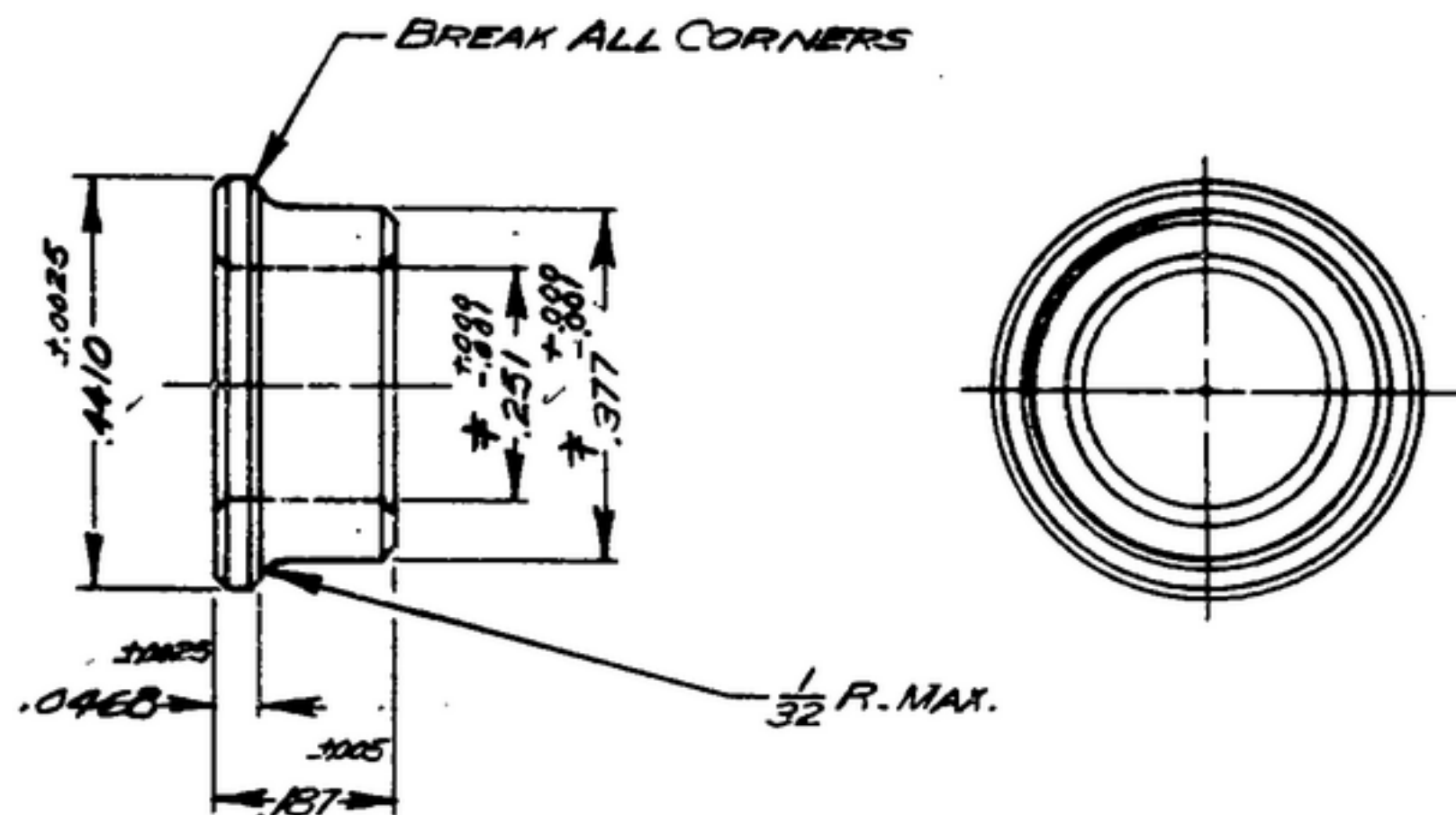

NOTES:

1. PART MAY BE # F-205-12 AS SUPPLIED BY UNITED STATES GRAPHITE CO, SAGINAW, MICH, OR EQUAL, PROVIDING IT MEETS THE FOLLOWING REQUIREMENTS & DIMENSIONS SHOWN.

LUBRICATION: OIL PER SPEC MIL-L-7870.

CONCENTRICITY BETWEEN DIMENSIONS MARKED * TO BE .0015 TIR

MATERIAL: POROUS BRONZE BEARING IN ACCORDANCE WITH SPEC MIL-B-5687, TYPE I, COMPOSITION A.

COLLINS PART NO.	ITEM	QTY	PART NO.	DESCRIPTION	MATL	MATL SPEC
LIST OF MATERIAL						
COLLINS PART NO. <i>559-024-002</i>						

				DRAWN <i>R.B.B.</i>	CHECKED <i>[Signature]</i>	APPROVED	COLLINS RADIO CO. -REAR-RAVDS-100A- <i>14214-FH-51-93</i>		BEARING	DEPARTMENT OF THE ARMY SIGNAL CORPS ENGINEERING LABORATORIES FORT MONMOUTH NEW JERSEY	
				UNLESS OTHERWISE SPECIFIED: DECIMAL DIMENSIONS INCLUDING HOLE SIZES MAY VARY ±.008 FRACTIONAL DIMENSIONS INCLUDING HOLE SIZES MAY VARY ±1/64 MACHINED ANGLES MAY VARY ±1° SHEARED ANGLES MAY VARY ±.25° BROKEN ANGLES MAY VARY ±1° ECCENTRICITY BETWEEN ANY DIAMETERS ON THE SAME CENTERLINE SHALL NOT EXCEED .010 TOTAL INDICATOR READING. ALL DIMENSIONS ARE FINISH DIMENSIONS INCLUDING APPLIED FINISH AND ARE GIVEN IN INCHES.			REVIEWED <i>PME</i>				
							APPROVED <i>HLV</i> <i>PME</i>				
							DATE <i>19 JAN '56</i>	SCALE <i>4/1</i>			
APPLICATION				SM-D-343601						SM-B-283157	
				SM-D-248980							
				SM-C-248980 SC-DL-248715							
COLLINS NO.	QTY	NEXT ASSY	USED ON								